

Below Ground: 3459 sq. ft, 321 m2, FLOOR 2: 8542 sq. ft, 794 m2
EXCLUDED AREAS: STORAGE: 1202 sq. ft, 112 m2, ELECTRICAL ROOM: 150 sq. ft, 14 m2, ELEVATOR: 49 sq. ft, 5 m2,
OPEN TO BELOW: 61 sq. ft, 6 m2

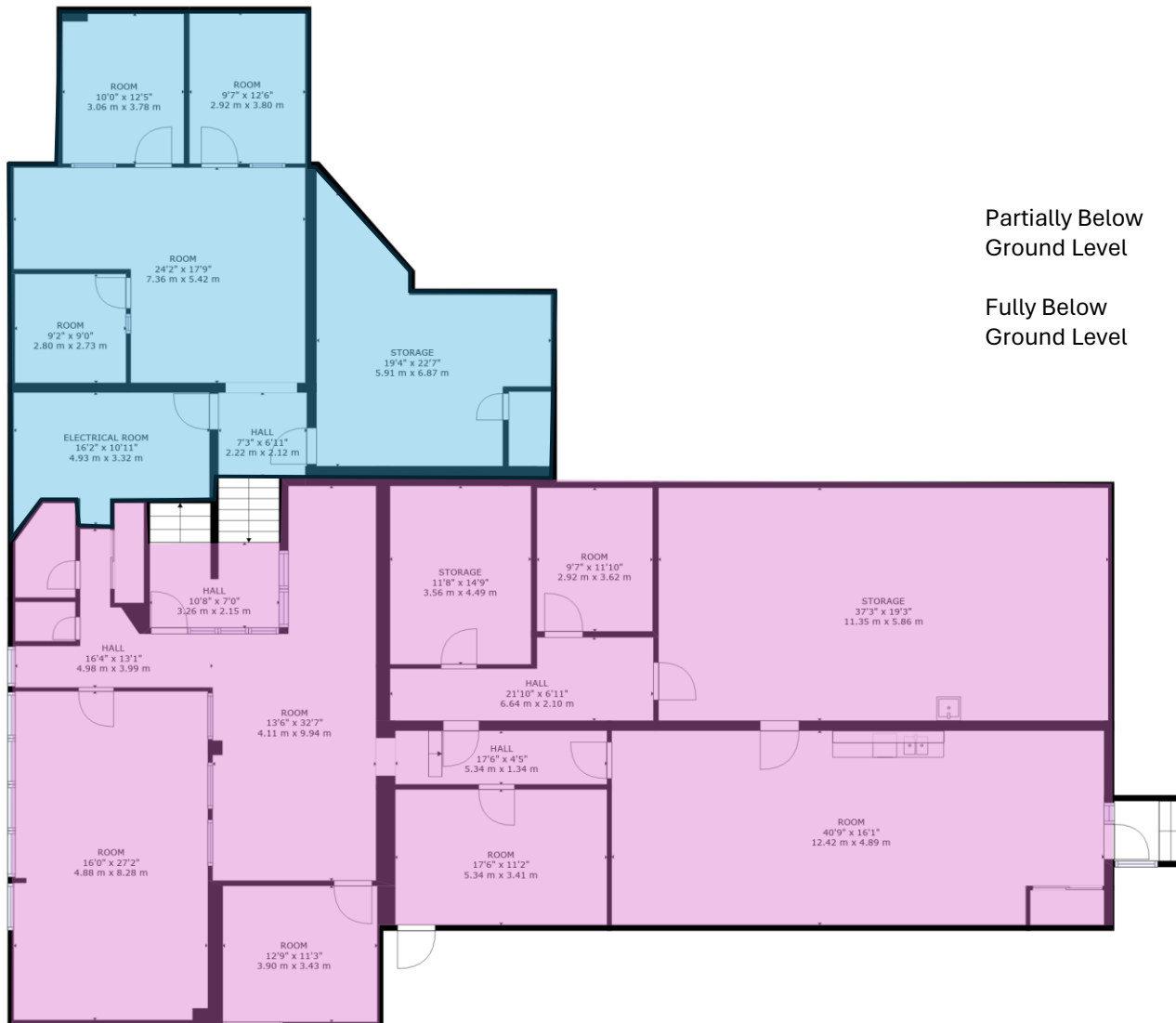

TOTAL: 12001 sq. ft, 1115 m2

Below Ground: 3459 sq. ft, 321 m2, FLOOR 2: 8542 sq. ft, 794 m2

EXCLUDED AREAS: STORAGE: 1202 sq. ft, 112 m2, ELECTRICAL ROOM: 150 sq. ft, 14 m2, ELEVATOR: 49 sq. ft, 5 m2, OPEN TO BELOW: 61 sq. ft, 6 m2